

RECORD OF SURVEY No. 32-85

IN THE UNINCORPORATED TERRITORY OF THE COUNTY OF MONO,
STATE OF CALIFORNIA, BEING SECTIONS 13, 24, AND 25,
TOWNSHIP 6 NORTH, RANGE 23 EAST, MOUNT DIABLO MERIDIAN

COUNTY SURVEYOR'S STATEMENT:

THIS MAP HAS BEEN EXAMINED IN ACCORDANCE WITH
SECTION 8766 OF THE PROFESSIONAL LAND SURVEYOR'S
ACT THIS 11th DAY OF October, 2011.

JOHN S. PARRISH, L.S. NO. 5050
COUNTY SURVEYOR



JOHNSON-FRANK & ASSOCIATES, INC.
ALAN D. FRANK, PLS
JULY 2010

RECORDER'S STATEMENT:

INSTRUMENT NO. 2011005440

FILED THIS 12th DAY OF OCTOBER, 2011
AT 3:10 P.M., IN BOOK 5 OF RECORD OF SURVEY
MAPS AT PAGES 8-86, AT THE REQUEST OF THE
UNITED STATES FOREST SERVICE.

LINDA ROBERTS BY Sherri A. Hale
COUNTY RECORDER DEPUTY COUNTY RECORDER

FEES \$0.00

BASIS OF BEARINGS:

THE BASIS OF BEARINGS FOR THIS RECORD OF SURVEY IS THE CALIFORNIA COORDINATE SYSTEM, NAD83 (CCS83) [2002.00 EPOCH], STATE PLANE GRID ZONE 3, AS DERIVED FROM THE CONTINUOUSLY OPERATING GPS (CGPS) STATIONS P135, P136, AND P654. POSITIONS FOR SAID CGPS STATIONS WERE DERIVED VIA THE NATIONAL GEODETIC SURVEY'S (NGS) ONLINE POSITIONING USER SERVICE (OPUS). TWENTY FOUR HOUR DATA SETS FOR EACH OF THESE CGPS SITES WERE SUBMITTED TO OPUS FOR DAYS 124 (MAY 4, 2010), 125 (MAY 5, 2010), AND 126 (MAY 6, 2010). THE THREE POSITIONS RETURNED VIA OPUS FOR EACH STATION WERE THEN AVERAGED AND HELD AS FIXED CONTROL. THE STANDARD DEVIATION OF THE MEAN FOR THE POSITION OF EACH STATION, AS DERIVED FROM THE NGS OPUS STANDARD DEVIATIONS ON EACH INDIVIDUAL RETURNED POSITION, ARE AS FOLLOWS:

| | HORIZONTAL | VERTICAL |
|------|------------|----------|
| P135 | +/-0.04' | +/-0.07' |
| P136 | +/-0.05' | +/-0.05' |
| P654 | +/-0.02' | +/-0.06' |

THIS BASIS OF BEARINGS IS SHOWN LOCALLY HEREON BY THE EAST LINE OF THE NORTHEAST 1/4 OF SECTION 24, BETWEEN STATIONS 700340 AND 700400, SAID LINE HAVING A GRID BEARING OF N02°01'45"W.

CONVERGENCE: GEODETIC AZIMUTH = GRID AZIMUTH + 0°40'40"

ALL BEARINGS SHOWN HEREON ARE GRID BEARINGS WITH THE EXCEPTION OF RECORD BEARINGS, WHICH ARE ALL TRUE NORTH BEARINGS.

BASIS OF COORDINATES:

THE BASIS FOR THE COORDINATES ON THIS RECORD OF SURVEY IS THE CCS83 (2002.00 EPOCH), ZONE 3, AS DETERMINED LOCALLY BY DIRECT GPS DUAL FREQUENCY STATIC TIES TO CGPS STATIONS P135, P136, AND P654 USING POSITIONS FOR SAID CGPS STATIONS DERIVED AS DESCRIBED ABOVE. SAID POSITIONS FOR SAID STATIONS ARE PART OF THE CALIFORNIA SPATIAL REFERENCE NETWORK (CSRN) IN THAT THEY MEET ALL OF THE REQUIREMENTS OF SECTION 8857 OF THE CALIFORNIA PUBLIC RESOURCES CODE (CPRC). THE OPUS DERIVED HORIZONTAL ACCURACIES ON THESE STATIONS MEET OR EXCEED THE FEDERAL GEOGRAPHIC DATA COMMITTEE (FGDC) 2-CENTIMETER ACCURACY CLASSIFICATION PER FGDC-STD-007.2-1998. SAID OPUS DERIVED POSITIONS FOR SAID CGPS STATIONS WERE HELD "FIXED" IN THIS SURVEY.

NO CPRC SECTION 8813.2 ACCURACY IS CLAIMED FOR THE COORDINATE POSITIONS DERIVED IN THIS SURVEY. HOWEVER, ALL FOUND MONUMENTS WERE TIED DIRECTLY TO THE THREE CONTROLLING CGPS STATIONS AS WELL AS TO AT LEAST TWO ONSITE CONTROL STATIONS USING DUAL FREQUENCY STATIC, POST-PROCESSED GPS, RESULTING IN A LOCAL NETWORK 95% CONFIDENCE OF ±0.18 FOOT (±5.0 CM) FOR THOSE STATIONS. THIS NETWORK ACCURACY EXCEEDS THAT SPECIFIED IN THE U.S. FOREST SERVICE'S "STANDARDS AND GUIDELINES FOR CADASTRAL SURVEYS USING GLOBAL POSITIONING SYSTEM METHODS", WHICH REQUIRES A LOCAL ACCURACY 95% CONFIDENCE ON CADASTRAL MEASUREMENTS OF LESS THAN ±0.33 FOOT (±10 CM).

SCALE FACTOR:

DISTANCES SHOWN HEREON ARE GROUND DISTANCES, UNLESS NOTED "GRID", WHICH INDICATES STATE PLANE GRID DISTANCES, SHOWN IN U.S. SURVEY FEET. TO OBTAIN GRID DISTANCES COMMENSURATE WITH STATE PLANE COORDINATES, MULTIPLY THE GROUND DISTANCES BY A COMBINED FACTOR (CF) OF 0.99963. THIS CF WAS COMPUTED AT THE EAST 1/4 CORNER OF SECTION 24, STATION 700340, AT AN ELEVATION OF 7424 FEET.

GRID DISTANCE = GROUND DISTANCE X 0.99963

PURPOSE OF SURVEY:

THE PURPOSE OF THIS SURVEY IS TO LOCATE, MONUMENT, MARK, AND POST THE NATIONAL FOREST PROPERTY BOUNDARY. SAID PROPERTY BOUNDARY LINES HAVE BEEN INTERVISIBLY POSTED AT A MAXIMUM INTERVAL DISTANCE OF 200 FEET.

THIS MAP IS BEING FILED PURSUANT TO THE PROFESSIONAL LAND SURVEYOR'S ACT, CHAPTER 15, ARTICLE 5, SECTION 8762, PARAGRAPH (A) & (B)(2), OF THE BUSINESS AND PROFESSIONS CODE.

HISTORY OF SURVEYS AND BOUNDARY DISCUSSION:

THERE HAVE BEEN TWO GOVERNMENTAL SURVEY EFFORTS WITHIN THE PROJECT AREA, AND SEVEN PRIVATE SURVEYS OF RECORD. ALL OF THESE SURVEYS ARE LISTED BELOW FOR REFERENCE, BUT NOT ALL OF THE SURVEYS ARE ACTUALLY REFERRED TO HEREON.

- R1) ORIGINAL SURVEY PLAT AND NOTES, T6N, R23E, MDM, APPROVED BY THE U.S. SURVEYOR GENERALS OFFICE ON MARCH 12, 1877
- R2) DEPENDENT RESURVEY OF THE SOUTH BOUNDARY OF T7N, R24E, A PORTION OF THE WEST BOUNDARY OF T6N, R25E, AND A PORTION OF THE EAST BOUNDARY OF T6N, R23E, AND THE RESURVEY AND SURVEY OF A PORTION OF THE SUBDIVISIONS OF T6N, R24E, MDM, APPROVED BY THE OFFICE OF THE U.S. SUPERVISOR OF SURVEYS, GENERAL LAND OFFICE, ON JULY 13, 1926
- R3) MAP BOOK 6, PAGE 11, FILED DECEMBER 4, 1968, AS INSTRUMENT NO. 2000
- R4) MAP BOOK 6, PAGE 37, FILED APRIL 14, 1969, AS INSTRUMENT NO. 3093
- R5) MAP BOOK 6, PAGE 76, FILED JANUARY 12, 1970, AS INSTRUMENT NO. 1577
- R6) PARCEL MAP NO. 32-29, PARCEL MAP BOOK 3, PAGE 26, FILED AUGUST 29, 1984, AS INSTRUMENT NO. 1790
- R7) RECORD OF SURVEY NO. 32-23, RECORD OF SURVEY MAPS BOOK 1, PAGE 98, FILED JUNE 12, 1984, AS INSTRUMENT NO. 8933
- R8) RECORD OF SURVEY NO. 32-32, RECORD OF SURVEY MAPS BOOK 2, PAGE 26, FILED MAY 19, 1987, AS INSTRUMENT NO. 8143
- R9) PARCEL MAP NO. 32-55, PARCEL MAP BOOK 4, PAGE 122, FILED SEPTEMBER 22, 2000, AS INSTRUMENT NO. 2000005538

IN RETRACING THE THREE SECTIONS SHOWN HEREON, WE FOUND THAT THE SURVEYS OF RECORD ARE GENERALLY TRUE AND CORRECT AS FILED, AND GENERALLY AGREE WITH ONE ANOTHER. WE DID NOT FIND ANY MAJOR DISCREPANCIES OR ENCROACHMENTS TO NATIONAL FOREST SYSTEM LANDS THOROUGHOUT THIS AREA.

| STATION | LATITUDE | LONGITUDE | (U. S. SURVEY FEET) | | STATION |
|---------|---------------|----------------|---------------------|------------|---------|
| | | | NORTHING | EASTING | |
| 600200 | 38-19-50.1782 | 119-24-39.8267 | 2308795.01 | 6874031.58 | 600200 |
| 600220 | 38-20-03.2163 | 119-24-39.8945 | 2310113.79 | 6874010.83 | 600220 |
| 600240 | 38-20-16.2545 | 119-24-39.9625 | 2311432.57 | 6873990.07 | 600240 |
| 600300 | 38-20-42.2841 | 119-24-40.2281 | 2314065.30 | 6873938.27 | 600300 |
| 600340 | 38-21-08.2356 | 119-24-40.6873 | 2316689.96 | 6873871.15 | 600340 |
| 600360 | 38-21-21.2091 | 119-24-40.9203 | 2318002.06 | 6873837.33 | 600360 |
| 600400 | 38-21-34.1826 | 119-24-41.1533 | 2319314.16 | 6873803.50 | 600400 |
| 600440 | 38-22-00.3117 | 119-24-41.5787 | 2321956.82 | 6873738.88 | 600440 |
| 600460 | 38-22-13.2302 | 119-24-41.7006 | 2323263.47 | 6873713.97 | 600460 |
| 600500 | 38-22-26.1487 | 119-24-41.8226 | 2324570.12 | 6873689.06 | 600500 |
| 620220 | 38-20-03.1693 | 119-24-23.4984 | 2310124.26 | 6875317.23 | 620220 |
| 620240 | 38-20-16.2174 | 119-24-23.5956 | 2311444.03 | 6875294.06 | 620240 |
| 620320 | 38-20-55.2274 | 119-24-24.0855 | 2315389.55 | 6875208.93 | 620320 |
| 620340 | 38-21-08.1513 | 119-24-24.3160 | 2316696.63 | 6875175.30 | 620340 |
| 620360 | 38-21-21.0387 | 119-24-24.5479 | 2318000.02 | 6875141.60 | 620360 |
| 640200 | 38-19-50.0633 | 119-24-06.9757 | 2308813.97 | 6876649.21 | 640200 |
| 640260 | 38-20-29.2511 | 119-24-07.3554 | 2312777.57 | 6876572.45 | 640260 |
| 640300 | 38-20-42.3223 | 119-24-07.4820 | 2314099.64 | 6876546.85 | 640300 |
| 640320 | 38-20-55.1943 | 119-24-07.7133 | 2315401.47 | 6876513.15 | 640320 |
| 640340 | 38-21-08.0656 | 119-24-07.9478 | 2316703.23 | 6876479.20 | 640340 |
| 640360 | 38-21-20.8649 | 119-24-08.1748 | 2317997.71 | 6876445.93 | 640360 |
| 640400 | 38-21-33.6634 | 119-24-08.4048 | 2319292.11 | 6876412.42 | 640400 |
| 640420 | 38-21-46.3616 | 119-24-08.5318 | 2320576.46 | 6876387.24 | 640420 |
| 640440 | 38-21-59.0598 | 119-24-08.6588 | 2321860.81 | 6876362.06 | 640440 |
| 640460 | 38-22-12.1571 | 119-24-08.7899 | 2323185.53 | 6876336.08 | 640460 |
| 640500 | 38-22-25.2544 | 119-24-08.9209 | 2324510.25 | 6876310.11 | 640500 |
| 660240 | 38-20-16.1414 | 119-23-50.7589 | 2311467.03 | 6877910.25 | 660240 |
| 660260 | 38-20-29.0481 | 119-23-50.9224 | 2312772.43 | 6877881.84 | 660260 |
| 660300 | 38-20-41.9522 | 119-23-51.0841 | 2314077.07 | 6877853.58 | 660300 |
| 660340 | 38-21-07.9800 | 119-23-51.4254 | 2316710.54 | 6877795.38 | 660340 |
| 660360 | 38-21-20.6902 | 119-23-51.7295 | 2317995.43 | 6877756.01 | 660360 |
| 660420 | 38-21-45.9236 | 119-23-52.3001 | 2320547.35 | 6877680.50 | 660420 |
| 660440 | 38-21-58.4470 | 119-23-52.5666 | 2321813.88 | 6877644.36 | 660440 |
| 660460 | 38-22-11.4879 | 119-23-52.3472 | 2323133.23 | 6877646.30 | 660460 |
| 700200 | 38-19-51.6867 | 119-23-33.4736 | 2309009.64 | 6879316.64 | 700200 |
| 700240 | 38-20-16.1022 | 119-23-34.2891 | 2311478.56 | 6879222.44 | 700240 |
| 700260 | 38-20-28.8446 | 119-23-34.4895 | 2312767.30 | 6879191.23 | 700260 |
| 700300 | 38-20-41.5869 | 119-23-34.6900 | 2314056.03 | 6879160.01 | 700300 |
| 700340 | 38-21-07.8930 | 119-23-34.9062 | 2316716.77 | 6879111.31 | 700340 |
| 700360 | 38-21-20.5148 | 119-23-35.2843 | 2317993.15 | 6879066.09 | 700360 |
| 700400 | 38-21-33.1366 | 119-23-35.6625 | 2319269.53 | 6879020.87 | 700400 |
| 700420 | 38-21-45.4850 | 119-23-36.0684 | 2320518.24 | 6878973.77 | 700420 |
| 700440 | 38-21-57.8335 | 119-23-36.4743 | 2321766.95 | 6878926.67 | 700440 |
| 700500 | 38-22-23.8027 | 119-23-35.3347 | 2324394.91 | 6878986.36 | 700500 |
| P135 | 38-42-16.6215 | 119-00-55.2827 | 2446554.01 | 6985372.15 | P135 |
| P136 | 38-45-40.9047 | 119-27-30.6405 | 2465514.37 | 6858675.58 | P136 |
| P654 | 38-03-28.5485 | 119-09-00.6265 | 2210483.56 | 6950295.84 | P654 |

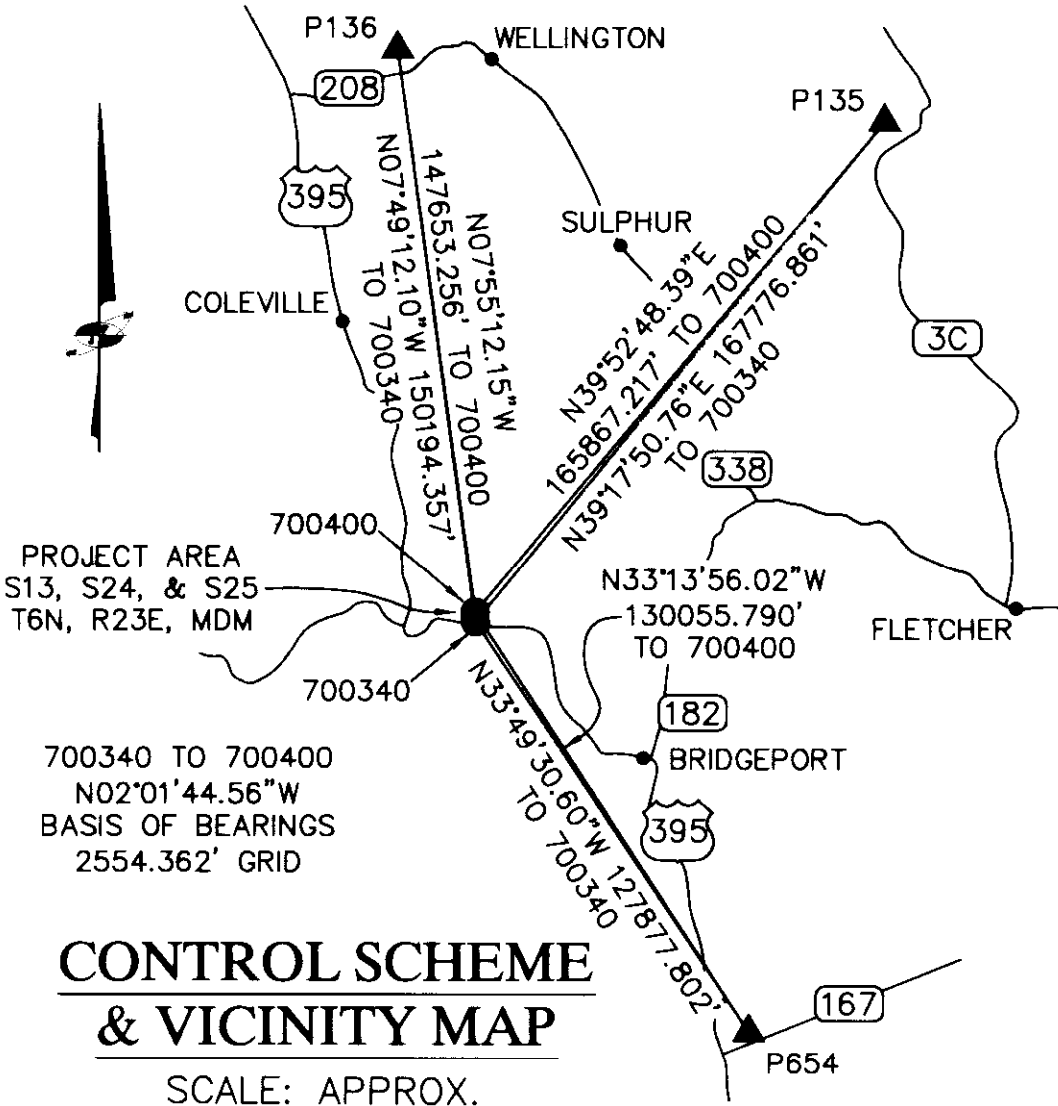

SURVEYOR'S STATEMENT:

THIS MAP CORRECTLY REPRESENTS A SURVEY MADE BY ME OR UNDER MY DIRECTION IN CONFORMANCE WITH THE REQUIREMENTS OF THE PROFESSIONAL LAND SURVEYOR'S ACT AT THE REQUEST OF THE USDA, FOREST SERVICE, IN MAY-JULY 2010.

ALAN D. FRANK, L.S. NO. 7172 CFDS 1091

