

Scale: one foot = 1320 feet
 10' " = 1320 "

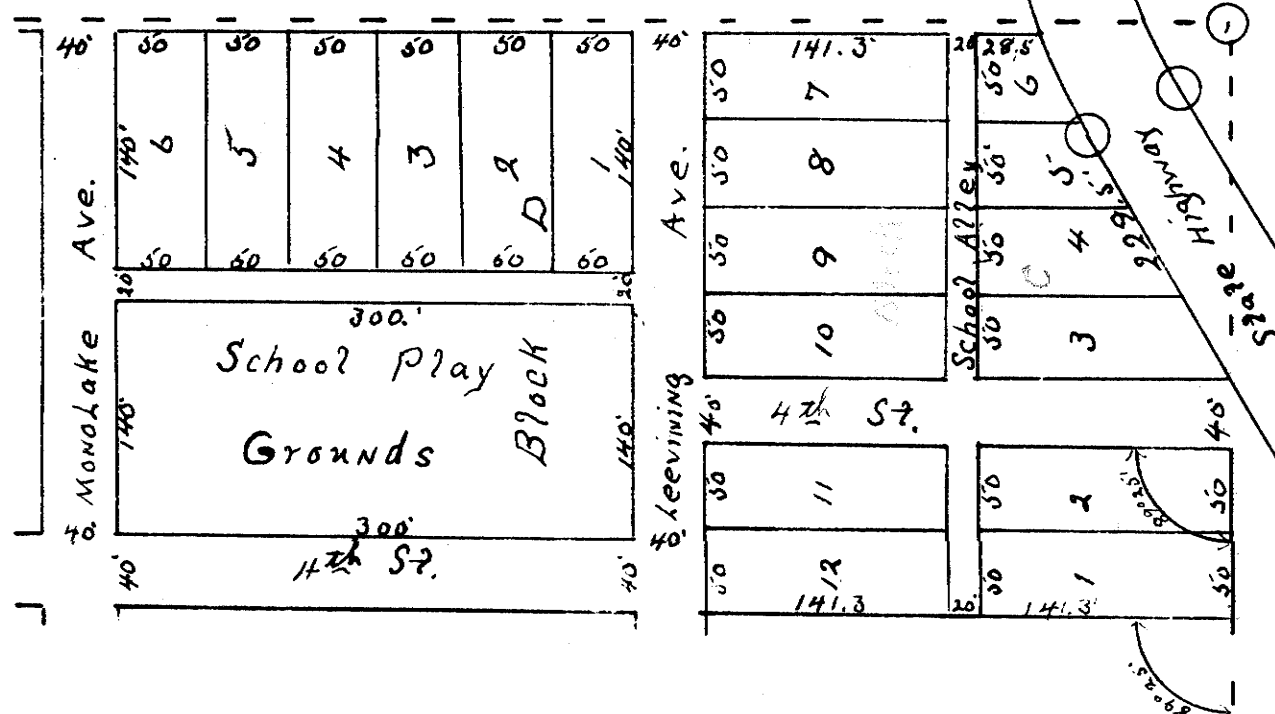

Supplement to the map of Leeving Township
 owner Christian Mattly

Board of Supervisors
 by A. W. Brandow Chairman

Surveyed and Plated by
 C. W. Fulton, C.W. Fulton
 County Surveyor of Mono County California

This Supplement Approved by me
 Christian Mattly

Dated Aug. 5th, 1929.

CANCELLED
 See New Map
 of Leeving
 Township

8 9
 N. S. Sec. Corner 17 16
 S. 89° 27' E 1319' 3957' To Sec. Cor.
 1/8 Corner

FILED OCT 1929
 A. C. DeLong