

PARCEL MAP 8118 MAP BK 300 PP 99-100

OWNER'S STATEMENT

THE UNDERSIGNED DO HEREBY STATE THAT THEY ARE THE OWNERS OF THE LAND DELINEATED AND EMBRACED WITHIN THE EXTERIOR BOUNDARY LINES OF THE HEREIN EMBODIED MAP ENTITLED "PARCEL MAP 8118, EDEN TOWNSHIP, ALAMEDA COUNTY CALIFORNIA", THAT SAID OWNERS ACQUIRED TITLE TO SAID LAND BY VIRTUE OF GRANT DEED RECORDED 09/30/2004 UNDER SERIES NO 2004-444172, OFFICIAL RECORDS OF ALAMEDA COUNTY CALIFORNIA, AND THAT THEY CONSENTS TO THE PREPARATION AND FILING OF THIS MAP.

AND THE UNDERSIGNED HEREBY DESIGNATES A 3' WIDE PUBLIC UTILITY EASEMENT ACROSS PARCEL "A" FOR THE BENEFIT OF PARCEL "B"

THE OWNERS OF PARCELS A AND B OF PARCEL MAP 8118 ARE SUBJECT TO TERMS COVENANTS, AND CONDITIONS AS SET FORTH BY THAT CERTAIN "JOINT MAINTENANCE AGREEMENT RECORDED 12/30/93 UNDER SERIES NO 93-456581, ALAMEDA COUNTY RECORDS.

*** USE WITH CAUTION ***
THIS IS A PUBLIC WORKS DEPARTMENT WORKING COPY OF AN OFFICIAL MAP ON FILE IN THE OFFICE OF THE COUNTY RECORDER, COUNTY OF ALAMEDA. OFFICE INFORMATION OR CALCULATIONS MAY HAVE BEEN ADDED HEREON.

OWNER'S ACKNOWLEDGEMENT

STATE OF CALIFORNIA)
COUNTY OF ALAMEDA) SS.

ON THIS 8 DAY OF June 2007, BEFORE ME Cora Judd A NOTARY PUBLIC IN AND FOR SAID COUNTY AND STATE, PERSONALLY APPEARED YONG QIANG MA AND HUI MEI MA PERSONALLY KNOWN TO ME OR PROVED TO ME ON THE BASIS OF SATISFACTORY EVIDENCE TO BE THE PERSONS WHOSE NAMES ARE SUBSCRIBED TO THE WITHIN INSTRUMENT AND ACKNOWLEDGED TO ME THAT THEY EXECUTED THE SAME IN THEIR AUTHORIZED CAPACITIES AND BY THEIR SIGNATURES ON THE INSTRUMENT, THE PERSONS OR THE ENTITY UPON BEHALF OF WHICH THE PERSONS ACTED EXECUTED THE SAME.

WITNESS MY HAND AND OFFICIAL SEAL

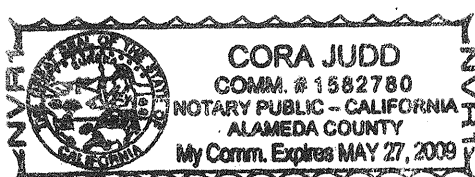

MY COMMISSION EXPIRES May 27, 2009

TRUSTEE'S ACKNOWLEDGEMENT

STATE OF CALIFORNIA)
COUNTY OF ALAMEDA) SS.
ON THIS 7th DAY OF Sept 2007, BEFORE ME KARENLEE DOUGHEATY A NOTARY PUBLIC IN AND FOR THE STATE OF CALIFORNIA PERSONALLY APPEARED TRACEY GANT PERSONALLY KNOWN TO ME (OR PROVED TO ME ON THE BASIS OF SATISFACTORY EVIDENCE) TO BE THE PERSON(S) WHOSE NAME(S) IS/ARE SUBSCRIBED TO THE WITHIN INSTRUMENT AND ACKNOWLEDGED TO ME THAT HE/SHE/ THEY EXECUTED THE SAME IN HIS/HER/ THEIR AUTHORIZED CAPACITY/IES, AND THAT BY HIS/HER/ THEIR SIGNATURE(S) ON THE INSTRUMENT THE PERSON(S) OR THE ENTITY UPON BEHALF OF WHICH THE PERSON(S) ACTED EXECUTED THE INSTRUMENT.

WITNESS MY HAND AND OFFICIAL SEAL

MY COMMISSION EXPIRES October 28, 2008
NUMBER 1522512

SURVEYOR'S STATEMENT

THIS MAP WAS PREPARED BY ME OR UNDER MY DIRECTION, AND IS BASED UPON A FIELD SURVEY IN CONFORMANCE WITH THE REQUIREMENTS OF THE SUBDIVISION MAP ACT AND LOCAL ORDINANCE AT THE REQUEST OF MR MARC MARGULIES ON FEBRUARY 28, 2004.

I HEREBY STATE THAT THIS PARCEL MAP SUBSTANTIALLY CONFORMS TO THE APPROVED OR CONDITIONALLY APPROVED TENTATIVE MAP IF ANY. I FURTHER STATE THAT THE MONUMENTS INDICATED HEREON ARE OF THE CHARACTER AND OCCUPY THE POSITIONS INDICATED AND THAT SAID MONUMENTS ARE SUFFICIENT TO ENABLE THE SURVEY TO BE RETRACED.

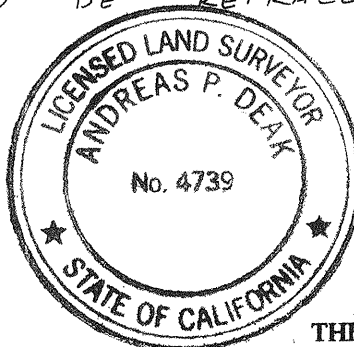

THE SHARED COMMON DRIVEWAY WILL BE MAINTAINED PER AMENDMENT TO THE JOINT MAINTENANCE AGREEMENT FOR PARCEL MAP 7009 RECORDED WITH ALAMEDA COUNTY RECORDERS ON JANUARY 29 2007, NO.2007045171

Andreas Deak
ANDREAS DEAK L.S. 4739
EXPIRATION 9-30-2007

COUNTY RECORDER'S STATEMENT

FILED THIS 04 DAY OF OCTOBER, 2007, AT 10:10 A.M.
IN BOOK 300 OF PARCEL MAPS, PAGES 99-100
AT THE REQUEST OF CHICAGO TITLE COMPANY

FEE: \$ 10.00
SERIES NO 2007351118



PATRICK O'CONNELL
COUNTY RECORDER IN AND FOR
COUNTY OF ALAMEDA, STATE OF
CALIFORNIA

BY [Signature]
DEPUTY COUNTY RECORDER

NOTES:

PARCEL "B" AS DELINEATED HEREON IS SUBJECT TO A DEED RESTRICTION WHICH IS RECORDED CONCURRENTLY ON THE 04 DAY OF OCTOBER 2007, UNDER SERIES NO 2007351119, OFFICIAL RECORDS OF ALAMEDA COUNTY, CALIFORNIA.

PARCEL "B" AS DELINEATED HEREON IS SUBJECT TO AN EXISTING JOINT MAINTENANCE AGREEMENT FOR THE MAINTENANCE OF THE PRIVATE ACCESS ROAD BUILT AS PART OF PARCEL MAP 7009. SAID AGREEMENT WAS RECORDED ON THE 30TH DAY OF DECEMBER 1993, UNDER SERIES NO 93-456581, AND WAS AMENDED ON THE 29th DAY OF January 2007 UNDER SERIES NO 2007045171 RECORDS OF ALAMEDA COUNTY CALIFORNIA.

TRUSTEE'S STATEMENT

Commonwealth Land Title Company AS TRUSTEE UNDER THE DEED DEED OF TRUST RECORDED: September 13, 2004, Inst. No. 2004-430976 RECORDS OF ALAMEDA COUNTY CALIFORNIA, CONSENTS TO THE PREPARATION AND FILING OF THIS MAP AND CONSENTS TO ALL OFFERS OF DEDICATION THEREOF

[Signature]
BY: TRACEY GANT

COUNTY SURVEYOR'S STATEMENT

I, RUSSELL REID PENLAND, JR, COUNTY SURVEYOR OF THE COUNTY OF ALAMEDA, STATE OF CALIFORNIA, DO HEREBY STATE THAT AFTER AN EXAMINATION OF THE HEREIN EMBODIED FINAL MAP ENTITLED "PARCEL MAP 8118, EDEN TOWNSHIP, ALAMEDA COUNTY CALIFORNIA," CONSISTING OF TWO (2) SHEETS, THIS STATEMENT BEING UPON SHEET (1) THEREOF, HAVE FOUND THE SUBDIVISION AS SHOWN UPON SAID MAP TO BE SUBSTANTIALLY THE SAME AS SAID SUBDIVISION APPEARS ON THE APPROVED TENTATIVE MAP AND ANY APPROVED ALTERATION THEREOF; THAT ALL PROVISIONS OF THE SUBDIVISION MAP ACT OF THE STATE OF CALIFORNIA AND AMENDMENTS THERETO AND OF LOCAL ORDINANCES APPLICABLE AT THE TIME OF APPROVAL OF THE TENTATIVE MAP HAVE BEEN COMPLIED WITH, THAT I AM SATISFIED THAT SAID MAP IS TECHNICALLY CORRECT.

IN WITNESS WHEREOF, I HAVE HEREUNTO SET MY HAND THIS 23RD DAY OF JUNE 2007.



Russell Reid Penland, Jr.
RUSSELL REID PENLAND

COUNTY SURVEYOR OF ALAMEDA
COUNTY, L.S. 5726
REGISTRATION EXPIRES 12-31-2007

CERTIFICATE OF CLERK OF THE BOARD OF SUPERVISORS

I, CRYSTAL HISHIDA GRAFF, CLERK OF THE BOARD OF SUPERVISORS OF THE COUNTY OF ALAMEDA, STATE OF CALIFORNIA, DO HEREBY CERTIFY THAT CERTIFICATES HAVE BEEN FILED, AND DEPOSITS HAVE BEEN MADE IN CONFORMANCE WITH THE REQUIREMENTS OF SECTIONS 66492 AND 66493 OF THE GOVERNMENT CODE OF THE STATE OF CALIFORNIA

DATED SEPTEMBER 10, 2007

CRYSTAL HISHIDA GRAFF

BY: [Signature]
DEPUTY CLERK \$10,655.00

PARCEL MAP 8118

EDEN TOWNSHIP, ALAMEDA COUNTY, CALIFORNIA

SCALE 1"=30'

MARCH 2004

ANDREAS DEAK
L.S. 4739
ALAMEDA CALIFORNIA

SHEET 1 OF 2 SHEETS